

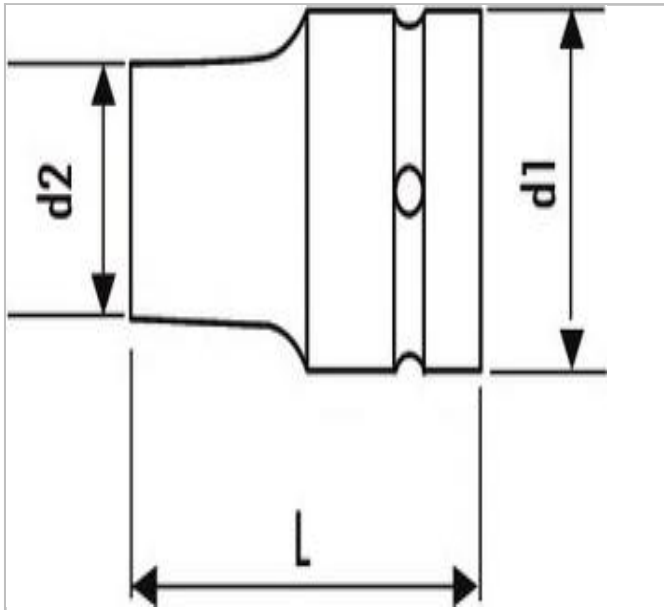

E113596 | EXPERT 1/2" Impact sockets - Hex - Metric



Description:

- Designed specifically to withstand demands of impact machinery.
- Chrome-Molybdenum steel.
- For your safety, use impact sockets with appropriate rings and pins.



	E113596
A [mm]	30.0
Diameter D1 [mm]	30.0
Length L [mm]	50.0
Weight [g]	240.0
Diameter D2 [mm]	42.0